

IT IS A VIOLATION OF LAW FOR ANY PERSON, UNLESS THEY ARE ACTING UNDER THE DIRECTION OF A LICENSED PROFESSIONAL ENGINEER, ARCHITECT, LANDSCAPE ARCHITECT, OR LAND SURVEYOR, TO ALTER AN ITEM IN ANY WAY. IF AN ITEM BEARING THE STAMP OF A LICENSED PROFESSIONAL IS ALTERED, THE ALTERING ENGINEER, ARCHITECT, LANDSCAPE ARCHITECT, OR LAND SURVEYOR SHALL STAMP THE DOCUMENT AND INCLUDE THE NOTATION "ALTERED BY" FOLLOWED BY THEIR SIGNATURE, THE DATE OF SUCH ALTERATION, AND A SPECIFIC DESCRIPTION OF THE ALTERATION.

REVISIONS	

(T) MANIUS/(T) SULLIVAN
SALT SPRINGS WATER PROJECT
WATER SERVICE CONNECTION
ONONDAGA/MADISON COUNTY, NEW YORK
(T) MANIUS/(T) SULLIVAN



Date
OCTOBER, 2020
Scale
AS SHOWN
Sheet Number
C100

Project Number
447.026/148.146

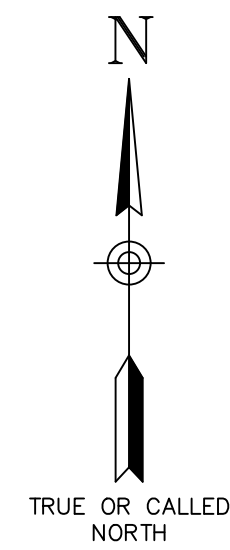

- NOTES:
1. OCWA REQUIRES THE INSTALLATION OF A METER PIT, AT THE COST OF THE PROPERTY OWNER, IF THE TYPICAL RESIDENTIAL HOUSE IS LOCATED MORE THAN 150 FEET FROM RIGHT-OF-WAY (ROW).
 2. PROPERTY OWNERS HAVE THE POTENTIAL ABILITY TO REUSE THE EXISTING WELL SERVICE PIPING IF MATERIAL IS COPPER OR IF INSTALLING A METER PIT.

RESIDENTIAL HOUSE LESS THAN 150 FEET FROM ROW

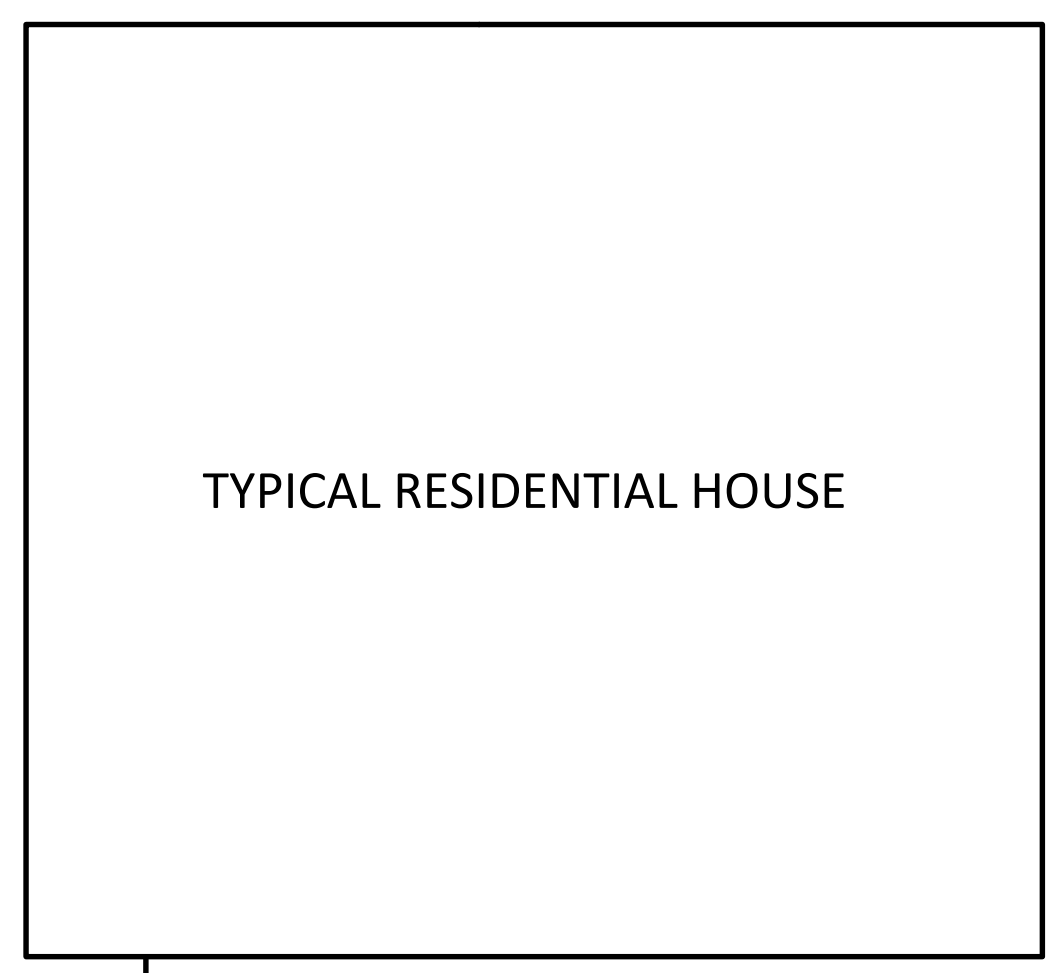

RESIDENTIAL HOUSE MORE THAN 150 FEET FROM ROW

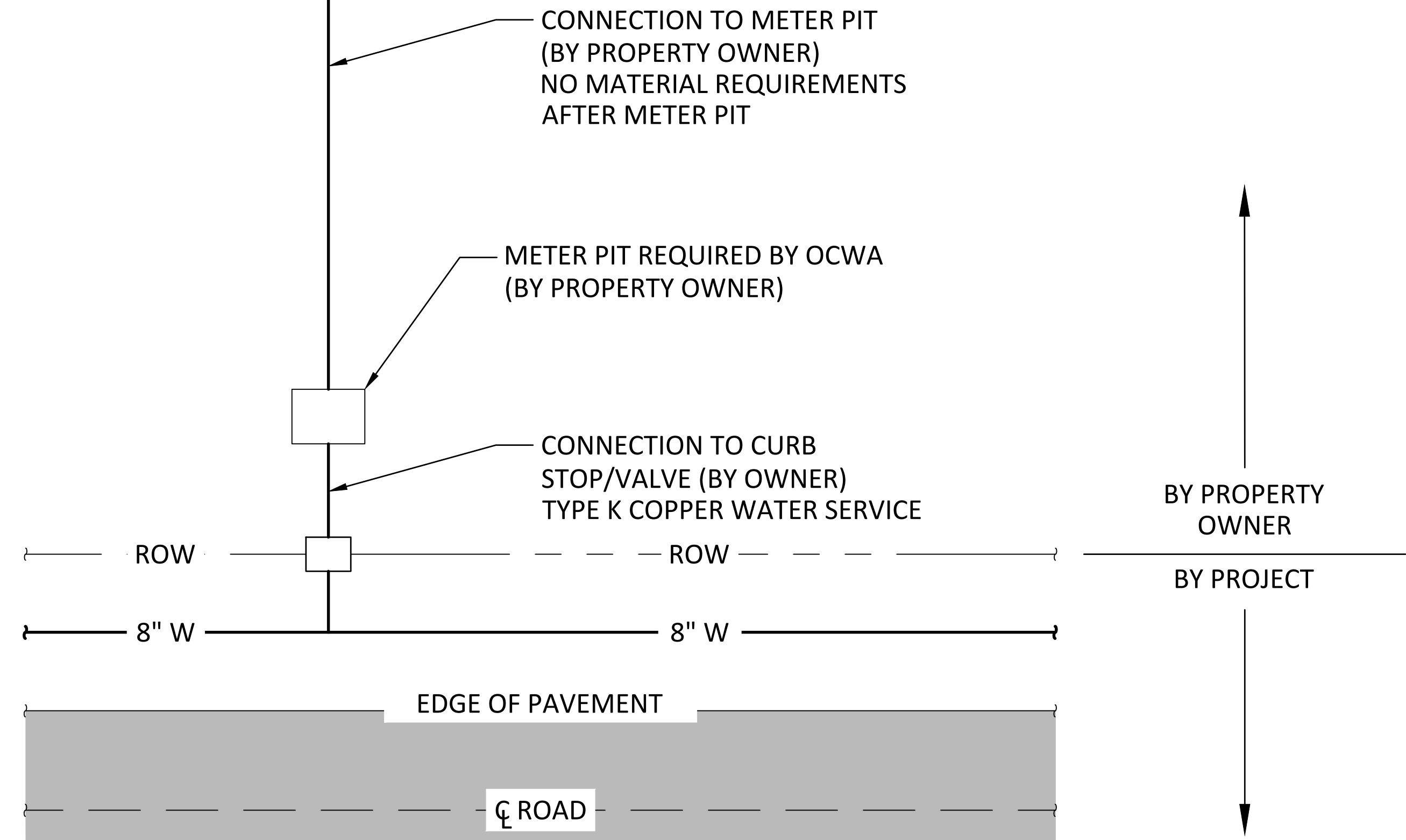
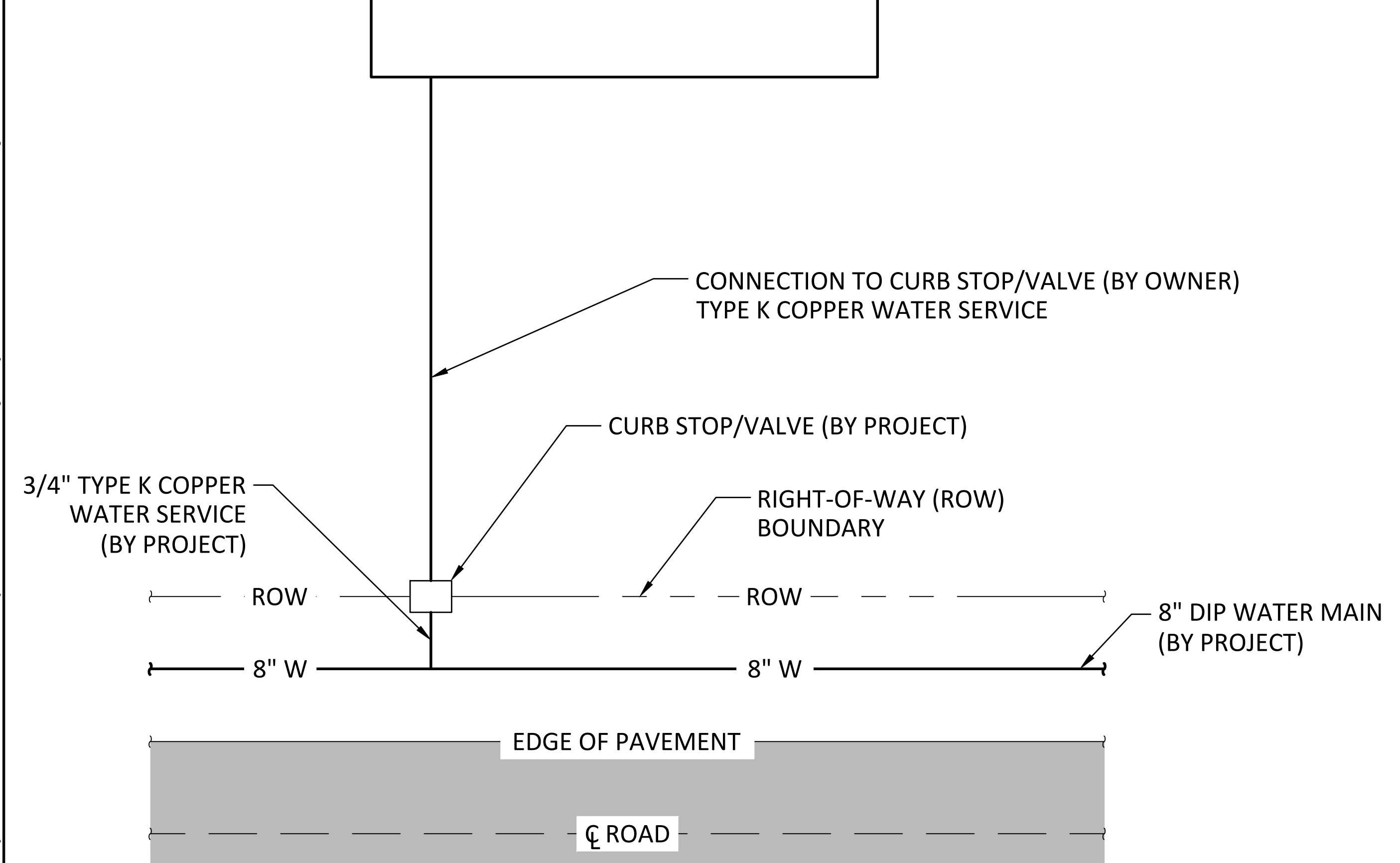
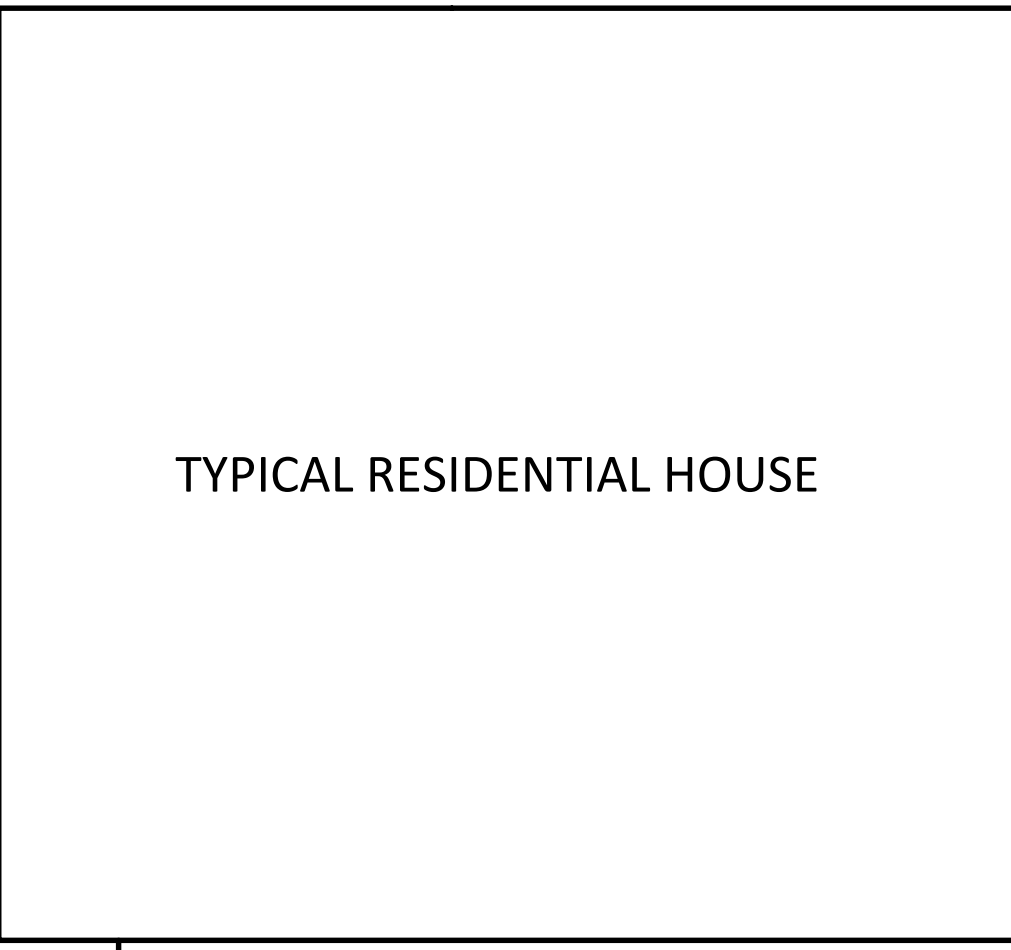

TYPICAL BUILDING WATER CONNECTION
NOT TO SCALE

Plotted: Nov 02, 2020 - 2:48PM
C:\Users\whicklen\Desktop\SaltSpringsWaterConnection.dwg
Checked by: INITIALS
Drawn by: OMH
Designed by: INITIALS
In charge of: INITIALS

By: ohicklen
SYR